

APRIL 13-14, 2008

GLOBAL AMERICAN SOUTH

Beyond the Sunbelt:
Southern Economic
Development in a
Global Context



UNC
GLOBAL

WELCOME

Dear Colleagues,

I am delighted to welcome you to the fourth annual *Global American South* conference. Through presentations and discussions, we explore the changing face of the southern United States and its interaction with the rest of the world in order to better understand both local and global dynamics. This year, we are focusing specifically on economic development, business and labor challenges, environmental concerns and opportunities, and the role technology and education play in helping to shape the best path forward.

The conference builds upon The University of North Carolina at Chapel Hill's long-standing tradition of being the intellectual center for studying the southern United States, and the *Center for Global Initiatives* is once again proud to co-sponsor this conference with UNC's *Center for the Study of the American South*. We are also pleased to have as co-sponsors UNC's *Office of Economic and Business Development* and *Quintiles Transnational Corporation*.

As always, we would greatly appreciate your feedback so please take a moment to fill out the evaluation survey that we are providing both on paper and online. Your thoughts are important as we map out future conferences and other collaborative initiatives that bring together academics, policy makers, practitioners, and community and corporate leaders.

Thank you again for being here and I hope you have a rewarding experience.

Sincerely,



Niklaus Steiner
Director
UNC Center for Global Initiatives

The Global American South conference is made possible by generous support from UNC's Center for Global Initiatives, Center for the Study of the American South, Office of Economic and Business Development, and by Quintiles Transnational Corp.



SCHEDULE

BEYOND THE SUNBELT

SOUTHERN ECONOMIC DEVELOPMENT IN A GLOBAL CONTEXT

April 13-14, 2008

The University of North Carolina at Chapel Hill

Sunday, April 13th

4:30 pm – 5:30 pm **Conference Registration – FedEx Global Education Center,
The University of North Carolina - Chapel Hill**

5:30 pm – 7:00 pm **Conference Opening and Keynote Lecture – Nelson Mandela Auditorium-
FedEx Global Center**

- Welcome and Introductions by Peter Coclanis, Associate Provost for International Affairs and Niklaus Steiner, Director, Center for Global Initiatives, The University of North Carolina - Chapel Hill
- **“Social Diversity and Politics in the Modern South”**
Keynote lecture by Merle Black, Asa Griggs Candler Professor of Politics and Government, Emory University

7:00 pm – 7:30 pm **Reception**

7:30 pm – 9:00 pm **Film Screening and Discussion – Nelson Mandela Auditorium, FedEx Global Center**

- Introduction by D.G. Martin, columnist, author and public television/radio host
- **“We Shall Not Be Moved- The Story of the Tillery Resettlement Community”**
Commentary and discussion with film director, Charles Thompson, Education and Curriculum Director, Center for Documentary Studies, Duke University
Special welcome to the Concerned Citizens of Tillery and
The Joyful Sound Gospel Choir of Tillery

Monday, April 14th

8:00 am – 9:00 am **Conference Registration and Continental Breakfast – The William and Ida Friday Center**

9:00 am – 10:30 am **Morning Plenary – Successful Southern Companies - Grumman Auditorium**

- Introduction by Peter Coclanis, Professor of History and Associate Provost for International Affairs, University of North Carolina - Chapel Hill
- **“Can North Carolina Be the Model for Success in a Global Economy?”**
Jeffrey Carlisle, Vice President, International Public Policy and Government Affairs, Lenovo
- **“Quintiles: Local Company with a Global Presence (est. 1982)”**
Paula Brown Stafford, Executive Vice President, Global Data Management and Biostatistics, Quintiles Transnational Corporation

SCHEDULE

10:45 am – 12:15 pm Morning Breakout Sessions

Breakout 1 – Technology for a Global Economy - Redbud A

- **“Toward Knowledge-Based Economic Strategies”**

Jim Clinton, Executive Director, Southern Growth Policies Board

- **“Neither Boom nor Gloom: The Economic Development of Huntsville, Alabama, 1940-1990.”**

Matthew Downs, Ph.D. Student, History Department, University of Alabama

- **“Locally Embedded and Globally Connected”**

J. Trent Williams, Principal and CEO, Regional Technology Strategies, Inc.

Breakout 2 – Education and Retraining - Redbud B

- **“Creating A Globally Competitive Workforce Through International Partnerships”**

Keith Bird, Chancellor, Kentucky Community and Technology College System

- **“The Luck of the Irish: Observations on Regional Development”**

Marion Coy, Chair, President, Galway-Mayo Institute of Technology, Ireland

- **“Connecting Business and Education on a Global Scale”**

Russ Yelton, Executive Director, Entrepreneurial Ventures and Business Incubation, Asheville-Buncombe Technical Community College

Breakout 3 – Uneven Effects Across Place and Sectors - Dogwood

- **“Work in the Two Souths: Challenges and Prospects.”**

Arne Kalleberg, Kenan Distinguished Professor of Sociology and Director of International Programs, College of Arts and Sciences, The University of North Carolina - Chapel Hill

- **“Globalization and Rural North Carolina: Impacts, Opportunities, and Perceptions”**

Catherine Moga Bryant, Senior Research Associate, N.C. Rural Economic Development Center

- **“Institutional Divergences and the Grounding of Reform and Recovery in North Carolina’s Traditional Sectors”**

Meenu Tewari, Associate Professor, City and Regional Planning, The University of North Carolina - Chapel Hill

12:30 pm – 1:30 pm Luncheon and Keynote Speaker – Trillium

- Welcome and Introduction by Jesse White, Director, Office of Economic and Business Development, The University of North Carolina – Chapel Hill

- **“Do Your Students Learn Hindi?”**

Keynote lecture by Martin Lancaster, President, North Carolina Community College System

1:45 pm – 3:15 pm Afternoon Plenary – Free and Fair Trade - Grumman Auditorium

- Introduction by Peter Coclanis, Professor of History and Associate Provost for International Affairs, The University of North Carolina – Chapel Hill

- **“Challenges and Opportunities in a Globalizing World”**

William Harrison, former Chairman and CEO, JP Morgan Chase

- **“Wal-Mart’s Long March to China”**

Nelson Lichtenstein, Professor of History, University of California - Santa Barbara

3:30 pm – 5:00 pm

Afternoon Breakout Sessions

Breakout 4 – Labor Movement and Demographic Shifts - Redbud A

• **“New People, New Work, New (New) South: Prospects For All Three”**

Leon Fink, Professor of History and Director, Work, Race, and Gender in the Urban World, University of Illinois - Chicago

• **“Agricultural Health and Safety Issues in North Carolina: Moving Fast, Moving Forward”**

Regina Luginbuhl, Bureau Chief, N.C. Department of Labor

• **“Working Conditions and Organizing Efforts at Smithfield Foods”**

Libby Manly, Community Organizer of Justice at Smithfield, United Food and Commercial Workers International

*Moderated by
Niklaus Steiner, Director,
Center for Global
Initiatives, University of
North Carolina-Chapel Hill*

Breakout 5 – Trade with China and India - Dogwood

• **“U.S.-India Relations Including Trade With China”**

Swadesh Chatterjee, CEO, Swadesh Chatterjee & Associates

• **“How North Carolina Can Compete with China and India in the Contemporary Global Knowledge Economy”**

Gary Gereffi, Professor of Sociology and Director, Center on Globalization, Governance and Competitiveness, Duke University

• **“Cotton Fields, Cargo Planes and Confucius: The Future of Economic and Cultural Partnerships Between Memphis and Beijing in ‘The Chinese Century’”**

Wanda Rushing, Associate Professor of Sociology and Director of Women’s Studies, University of Memphis

*Moderated by
Jesse White, Director,
Office of Economic and
Business Development,
University of North
Carolina-Chapel Hill*

Breakout 6 – Environmental Concerns and Opportunities - Redbud B

• **“Meeting Future Water Demands in the Face of Rapid Development”**

Greg Characklis, Associate Professor, Department of Environmental Sciences and Engineering, The University of North Carolina - Chapel Hill

• **“Energy Efficiency Technologies for Sustainable Development”**

Dana Christensen, Associate Laboratory Director, Energy and Engineering Sciences Directorate, Oak Ridge National Laboratory

• **“Sustainability: From Global Context to Local Solutions”**

Frank Phoenix, Partner, Greenbridge Developments

*Moderated by
Harry Watson, Director,
Center for the Study of
the American South,
University of North
Carolina-Chapel Hill*

5:00 pm – 7:00 pm

Dinner and Keynote Speaker – Trillium

• Welcome and Introduction by Bernadette Gray-Little, Executive Vice Chancellor and Provost, The University of North Carolina – Chapel Hill

• **“The World Grows Up: Competing with Real Competitors on the Global Stage”**

Keynote lecture by Michael Crow, President, Arizona State University

SPEAKERS

KEITH W. BIRD was appointed Chancellor of the Kentucky Community and Technical College System in February 1999. He previously served as President of Central Carolina Technical College and New Hampshire Regional Community Technical College at Claremont and Nashua. He also was Deputy Commissioner of the New Hampshire Community Technical College System. Bird has also served as Provost/Senior Vice President of Hesser College; Director of Operations and Training for New Hampshire Job Training Councils; and Director of the New Hampshire Continuing Education Network, a Kellogg-funded project of the New Hampshire College and University Council. Bird received his B.A. from Alma College and his M.A. and Ph.D. from Duke University.

MERLE BLACK is the ASA Griggs Candler Professor of Politics and Government in the Department of Political Science at Emory University. Black's specialization is American politics, especially the politics of the modern South. His current research projects concern the rise of the Republican Party in the South and the consequences for national politics, the changing electorate of the South, and the politics of the Deep South states. His most recent book, *Divided America: The Ferocious Power Struggle in American Politics*, co-written with his twin brother Earl, a Professor at Rice University, was published last year. It details the fissures in American politics, paying close attention to geographical differences. Black received a B.A. from Harvard College, and M.A. and Ph.D. from the University of Chicago.

JEFFREY CARLISLE is Vice President, International Public Policy and Government Affairs, for Lenovo. He is responsible for managing the company's positions on public policy issues around the world. In this role, Carlisle provides corporate and strategic counsel and oversees government relations. Carlisle came to Lenovo after having spent a number of years as a leading telecommunications attorney. He also served as Deputy Chief and then Chief of the Wireline Competition Bureau at the FCC, where he managed the development of the commission's policies on broadband and competitive entry into the local exchange market and was the architect of the commission's policies on VoIP and bankruptcy of common carriers. Carlisle has lectured extensively on policy issues in the field of telecommunications, and more recently on global trade and national security. He received a B.A. from UCLA, a J.D. from the University of California, Berkeley, and a M.A. in Law and Diplomacy from The Fletcher School.

GREGORY W. CHARACKLIS is Associate Professor in the Department of Environmental Sciences and Engineering at the University of North Carolina at Chapel Hill. His primary research interests involve integrated planning of water supply and treatment strategies through the consideration of both engineering and economic criteria. He also directs several laboratory and field studies that explore the role particles play in microbial transport. Prior to joining UNC, Characklis spent two years as Director of Resource Development and Management at Azurix Corp. He holds a Ph.D. and an M.S. in Environmental Science and Engineering from Rice University and a B.S. in Materials Science and Engineering from Johns Hopkins University.

SWADESH CHATTERJEE is a successful businessman, entrepreneur, advocate and one of the co-founders and past President of TIE Carolinas, whose primary goal is to develop and assist entrepreneurs. He was Chairman and co-founder of the U.S.-India Friendship Council, a coalition of Indian American individuals and associations that lobbied Washington to ensure passage of the U.S.-India Civilian Nuclear Deal. Long a proponent of U.S. - India trade, Chatterjee has been instrumental in bringing Indian trade delegations to North Carolina and Washington. He has served as national President of the Indian American Forum for Political Education and currently serves on the Advisory Board for International and Area Studies at UNC-Chapel Hill. Chatterjee has received numerous awards including the Padma Bhushan, one of India's highest civilian awards, by the President of India in 2001. He has a B.S. in Physics from Calcutta University, a B.S. in Instrumentation and Electronic Engineering from Jadavpur University, and a M.B.A from North Carolina State University.

DANA CHRISTENSEN is Associate Laboratory Director, Energy and Engineering Sciences Directorate at Oak Ridge National Laboratory (ORNL). The Energy and Engineering Sciences Directorate is the U.S. Department of Energy's largest energy laboratory, executing programs for a variety of government and industrial sponsors in all dimensions of energy science and technology. Christensen came to ORNL from Los Alamos National Laboratory where he was the Principal Associate Laboratory Director for Threat Reduction. He has twenty-nine years of management experience in material science, nuclear energy, fossil and renewable energy, nuclear materials management and scientific research in support of DOE and other government agencies.

JIM CLINTON is Executive Director of the Southern Growth Policies Board, having previously served as President of the Louisiana Partnership for Technology and Innovation and President of Gulf South Research Institute. He has also served in a variety of state government positions in Louisiana and currently serves as a board member for the Southern Arts Federation, the National Policy Consensus Initiative, the Trans-Atlantic Technology and Training Alliance and the Institute for Rural Journalism and Policy Issues. In 2007, Alabama Governor Bob Riley appointed Clinton as a special advisor to the executive council of the Rural Alabama Action Commission, and Federal Communications Chairman Kevin Martin has also appointed Clinton to serve as a member of the FCC's Consumer Advisory Committee. He has been a lead author for a number of Southern Growth Policies Board reports and written for regional and national publications. His book of poetry, *What is Fair* was published by Louisiana State University Press.

PETER COCLANIS is Albert R. Newsome Professor of History and Associate Provost for International Affairs at UNC-Chapel Hill. As Associate Provost, Coclanis is responsible for leading strategy planning for international efforts and the coordination of international activities for the university. He is also an Adjunct Professor in Economics and a Faculty Affiliate in the Department of Asian Studies, having served as Associate Dean for General Education and Chair of the History Department at UNC. Coclanis works primarily in economic and business history and is currently working on a project on the creation of integrated world markets for tropical and semi-tropical commodities, with a special emphasis on rice.

SPEAKERS

MARION COY is President of the Galway-Mayo Institute of Technology, (GMIT) Ireland, where she is strongly committed to furthering the tripartite public service mission of the Institute: the promotion of economic development, social cohesion and regional growth. In her time at GMIT, Coy has served as a lecturer in communications, established a new Department of Humanities and successfully lobbied for the establishment of an arts-based campus, subsequently becoming Head of Centre and Head of the amalgamated Schools of Business Studies and Humanities. She oversees four campuses - Castlebar (Mayo), Cluain Mhuire (Galway city), Dublin Road (Galway city) and Letterfrack (Connemara) and has worked on a number of national and regional projects towards the development of tertiary education in Ireland. Coy contributed to the deliberations of the Points Commission, the development of the Bologna Process, the establishment of Lionra and the development of a national quality framework for the Institutes of Technology. She graduated with a degree in History and English from University College Galway.

MICHAEL CROW is President of Arizona State University which has marked a number of important milestones since he took office in 2002, including the establishment of several major interdisciplinary research initiatives and more than a dozen new interdisciplinary schools. Crow has also initiated an important infrastructure expansion to create more than seven million square feet of new academic space. Prior to joining ASU, Crow was Executive Vice Provost at Columbia University, where he also was Professor of Science and Technology Policy in the School of International and Public Affairs. He has been a senior advisor to the U.S. Department of State and Department of Commerce, a Fellow of the National Academy of Public Administration and a member of the Council of Foreign Relations. Crow is the author of numerous books and articles relating to the analysis of research organizations, technology transfer, science and technology policy and the theory/practice of public policy.

MATTHEW DOWNS is a Ph.D. student in the History Department at the University of Alabama. He is currently working on his dissertation, *Creating a "Different Citizen": The Federal Development of the Tennessee Valley, 1916-1961*. Downs serves as the Editor of the *Southern Historian*, a graduate journal featuring articles on southern history.

LEON FINK is Distinguished Professor of History and Director of the Work, Race, and Gender in the Urban World graduate program at the University of Illinois at Chicago. His research and writing focuses on labor unions in the United States, immigration and the nature of work. He is the editor of *Labor: Studies in Working-Class History of the Americas*, the premier journal of labor history in the United States. Seeking the roots of today's "globalized" economic order, Fink is currently at work on a study of maritime labor regulation, 1800-2000. He is the author or editor of seven books and numerous articles, a Fulbright Senior Scholar and past NEH Fellow. Fink has also taken a leading role in national history education circles, where he has stressed the necessary collaboration between the university and the public schools.

GARY R. GRANT has served as the Executive Director of the Concerned Citizens of Tillery (CCT) for the past twenty-seven years. He is also the founding President of the National Black Farmers & Agriculturalists Association; Director of the National Land Loss Fund; a founder and chair of the African American Environmental Action Justice Network, a founder and co-director of the North Carolina Environmental Justice Network, and founding chair of the Black Family Land Trust. Grant was reared on family farm #50 in the New Deal community of Tillery Farms, in Halifax County, N.C. where he has taught in the community and the Halifax County school system. Grant has appeared on CBS's 60 Minutes, N.C. Public Television and authored or co-authored several papers on the destruction of the environment by corporate hog growing facilities and the decline of Black farmers in America. He has a B.A. degree from North Carolina College at Durham (now NCCU), and an Honorary Doctorate of Humanities from Eastern North Carolina Theological Institute.

GARY GEREFFI is Professor of Sociology and Director of the Center on Globalization, Governance and Competitiveness at Duke University. His research interests deal with social and environmental certification in global industries, the competitive strategies of global firms, and industrial upgrading in East Asia and Latin America. Gereffi's ongoing research projects include industrial upgrading in East Asia, North America, and Eastern Europe/Central Asia; a comparative analysis of global restructuring in the apparel, automotive, computer, and retail sectors; and a study of the emergence of public and private governance systems in the Americas. Currently, he is writing a book on global value chains and industrial upgrading

WILLIAM B. HARRISON JR. is the former Chair and CEO of JPMorgan Chase. Previously he held the position of CEO of Chase Manhattan Corporation and presided over the mergers with JPMorgan in 2000 and Bank One in 2004. Harrison joined Chemical Bank in 1967 in New York, moved to San Francisco to open the bank's first regional office, and then spent five years in London managing the firm's European business. He returned to the U.S. in 1983 and was put in charge of the bank's Global Banking and Corporate Finance Group. He has played a leading role in managing and merging the major firms - Chemical, Manufacturers Hanover, Chase Manhattan, JPMorgan and Bank One, in addition to Hambrecht & Quist, Flemings and Beacon creating one of the leading global financial institutions in the world. Harrison is a director of Merck & Co., Inc, and Cousins Properties, Inc.

SPEAKERS

ARNE L. KALLEBERG is a Kenan Distinguished Professor of Sociology and the Director of International Programs in the College of Arts and Sciences at the University of North Carolina at Chapel Hill. He received his B.A. from Brooklyn College and his M.S. and Ph.D. from the University of Wisconsin- Madison. He was a Professor of Sociology at Indiana University-Bloomington before joining the faculty at UNC-Chapel Hill in 1986. Kalleberg has published more than 100 articles and chapters and ten books on topics related to the sociology of work, organizations, occupations and industries, labor markets, and social stratification His most recent books are *The Mismatched Worker* (W.W. Norton, 2007) and *Ending Poverty in America: How to Restore the American Dream* (co-edited with John Edwards and Marion Crain, New Press, 2007). Kalleberg is the 2008 President of the American Sociological Association.

H. MARTIN LANCASTER has served as President of the North Carolina Community College System since 1997. With 58 institutions and almost 800,000 students, the system is one of the largest in the country and the state's primary agency for delivery of job training, literacy and adult education. Lancaster's major initiatives have been to increase state and private funding for facilities, equipment, faculty salaries and instruction and to strengthen the system's essential role in workforce and economic development. He has focused particular efforts on increasing the role of community colleges in preparing "home grown teachers" for public schools and in workforce training for biotechnology and other high-tech industries. Previously, Lancaster has served as Assistant Secretary of the Army (Civil Works), Special Advisor to the President on Chemical Weapons, as well as a member of the U.S. House of Representatives and a member of the North Carolina House of Representatives

NELSON LICHTENSTEIN is Professor of History at the University of California, Santa Barbara, where he directs the Center for the Study of Work, Labor and Democracy. He is the author of numerous books and edited collections including, *Walter Reuther, the Most Dangerous Man in Detroit*, (University of Illinois Press, 1991), *State of the Union: A Century of American Labor* (Princeton University Press, 2002), *American Capitalism: Social Thought and Political Economy in the 20th Century* (University of Pennsylvania Press, 2006), and *Wal-Mart: The Face of 21st Century Capitalism* (New Press, 2006). Metropolitan Books will publish his history of that company in 2009

REGINA LUGINBUHL is Bureau Chief for the North Carolina Department of Labor's Agricultural Safety & Health Bureau which inspects migrant housing, presents agricultural safety training programs in English and in Spanish, and conducts agricultural accident and fatality investigations. She has served as an Adjunct Professor at the UNC School of Public Health and is currently a member of East Carolina University's Board of Collaborators. Luginbuhl is a graduate of the University of Michigan, and has a M.S. in Rural Sociology from N.C. State University.

LIBBY MANLY is a community organizer with the Justice at Smithfield campaign of the United Food and Commercial Workers International Labor Union. She mobilizes the support of religious leaders, immigrant advocates, the civil rights community, students and consumers to support workers at the world's largest hog processing plant -Smithfield Packing, in Tar Heel, N.C. Prior to her involvement on the Justice at Smithfield campaign, Manly worked as Program Director at Student Action with Farmworkers.

D.G. MARTIN grew up in Davidson, North Carolina and graduated from Davidson College. After two years in the U.S. Army Special Forces and a law degree from Yale, he practiced law for 20 years. He has served as a Vice President of the University of North Carolina system, interim Vice Chancellor at UNC-Pembroke and North Carolina Central University, the Carolinas Director of the Trust for Public Land, interim Executive Director of the Triangle Land Conservancy, and interim Director of the North Carolina Clean Water Management Trust Fund. He writes a weekly column, *One on One*, published in about 40 North Carolina newspapers, and he is the host of the UNC-TV North Carolina *Bookwatch* series and the WCHL radio show "Who's Talking." He is also a regular contributor to *Our State magazine*, which is the publisher of his book, "Interstate Eateries".

CATHERINE MOGA-BRYANT is Senior Research Associate with the North Carolina Rural Economic Development Center, a non-profit dedicated to improving quality of life in the state's 85 rural counties through sound economic and community development strategies. In her role at the center, she conducts research on a variety of issues related to rural North Carolina including, entrepreneurship, workforce development, globalization, and poverty. Moga-Bryant holds a Master's degree in Geography from the UNC- Chapel Hill.

FRANK PHOENIX is a partner in Greenbridge Developments, currently building a 226,000 square foot mixed-used 'green' building in downtown Chapel Hill, and a partner in New Southern Land Company, developing a 12-home 'green community'. The focus and mission behind both firms is the promotion of sustainable development embodying principles of economic viability, environmental responsibility, and social equity. Previously he worked as an environmental engineer measuring air pollution for private industry and the EPA. Phoenix currently serves on the board of directors of the Fenwick Foundation, the board of directors of the Triangle Community Foundation, the advisory board of VISIONS, Inc, and the advisory board of the Institute of Sustainable Development at the Chapel Hill – Carrboro Chamber of Commerce.

WANDA RUSHING is Associate Professor of Sociology and Director of Women's Studies at the University of Memphis. She has published articles on southern economic development, racial inequality, and the impact of globalization on Memphis. Rushing is the author of *Globalization and the Paradoxes of Place: Poverty and Power in Memphis*, (forthcoming 2009, University of North Carolina Press) and Editor of the "Urbanization volume" (in progress) of the *New Encyclopedia of Southern Culture* (University of North Carolina Press).

SPEAKERS

PAULA BROWN STAFFORD is Executive Vice President, Global Data Management and Biostatistics, for Quintiles Transnational Corp. Stafford has held numerous positions during her 20 plus years with Quintiles including positions in Project Management, Business Development, Scientific Operations, and General Management. In addition to her role at Quintiles, Stafford has been a member of the board of directors of Bio-Imaging Technologies, Inc. and CDISC (Clinical Data Interchange Standards Consortium). She is also on the advisory board to the RTP chapter of the Healthcare Businesswoman's Association and on the industry advisory board to the BioPharma Management Initiative at N.C. State University's College of Management. Stafford holds a Bachelor of Science and a Masters in Public Health, both from the UNC - Chapel Hill with a specialization in Biostatistics.

NIKLAUS STEINER is Director of the Center for Global Initiatives at the University of North Carolina - Chapel Hill. A native of Switzerland, Steiner earned his Ph.D. in Political Science and International Relations at Northwestern University. His research and teaching interests include refugees, nationalism, and national identity, and his publications include *Arguing About Asylum: The Complexity of Refugee Debates in Europe* (St. Martin's); *The Problems of Protection: UNHCR, Refugees, and Human Rights*, eds. Steiner, Gibney and Loescher (Routledge); *Regionalism in the Age of Globalism*, eds. Hvnnighausen, Frey, Peacock, and Steiner (Wisconsin); and *The Age of Apology: The West Confronts its Past*, eds. Gibney, Howard-Hassmann, Coicaud and Steiner (University of Pennsylvania Press). He is currently writing an undergraduate textbook on international migration and citizenship to be published by Routledge.

MEENU TEWARI, Associate Professor in the Department of City and Regional Planning at UNC-Chapel Hill, focuses on ethnographic and institutional understandings of how the role of the state, the organization of work and the processes of local economic development are being re-shaped in this era of globalization and economic integration. She is currently working on three projects: a NSF-funded Global Apparel Project; a project on the nature of skill and demand diffusion within South Asia's emerging regional networks of garment production and distribution, funded by the Asian Development Bank; and a comparative project on labor displacement and re-adjustment in North Carolina's textile and furniture industry. Tewari's most recent papers were published in *Environment and Planning A*, *The Global Economy Journal*, *Oxford Development Studies* and forthcoming in *Competition and Change*.

CHARLES D. THOMPSON is Education and Curriculum Director at the Center for Documentary Studies and Adjunct Professor of Religion and Cultural Anthropology at Duke University. Thompson is an oral historian, filmmaker and ethnographer who writes and teaches about agriculture, religion and culture in Latin America, Appalachia and the American South. He is the co-author with Melinda Wiggins of *The Human Cost of Food: Farmworkers Lives, Labor and Advocacy* (University of Texas Press).

HARRY WATSON is Professor of History and Director of the Center for the Study of the American South at The University of North Carolina-Chapel Hill. The center's mission is to extend the historic role of the university as the premier institution for research, teaching, and public dialogue on the history, culture, and contemporary experience of the American South and also serves as the university's primary vehicle to promote initiatives in this tradition of regional service and scholarship. Watson's specialties are the antebellum South, Jacksonian America, and the history of North Carolina. He is co-Editor of the journal, *Southern Cultures* and author of *Andrew Jackson Versus Henry Clay: Democracy and Development in Antebellum America* (Bedford Series in History & Culture).

J. TRENT WILLIAMS is Principal and CEO of Regional Technology Strategies, Inc. where he plays a leadership role in RTS projects and research activities focusing on regional economic development, entrepreneurship, developmental finance, high value-added manufacturing, R&D management, technology development and commercialization, and strategic planning. He has served as a founding Director of eight technology-based companies, as well a faculty member at UNC's Kenan-Flager Business School's Center for Entrepreneurship and Technology Venturing. In his capacity as RTS Principal, Williams currently functions as the economic development advisor to the Rapides Foundation in Alexandria, Louisiana. He has served as Undersecretary of the Louisiana Department of Commerce, Vice President and Research Director at Gulf South Research Institute, and chair/co-chair or member of over 20 state, regional and national committees and councils.

JESSE WHITE is Director of the Office of Economic and Business Development and an Adjunct Professor in the School of Government at The University of North Carolina-Chapel Hill. Prior to coming to UNC in 2003, he served for almost nine years as Federal Co-Chairman of the Appalachian Regional Commission; and from 1982-1990, he led the Southern Growth Policies Board as its Executive Director. White has also been a Fellow at the Institute of Politics at Harvard University and a private consultant in economic development. He is a Fellow of the National Academy of Public Administration, serves on the boards of Regional Technology Strategies, Rural LISC, the Institute for Rural Journalism and Community Issues, and the Association of Appalachian Colleges.

RUSS YELTON is Executive Director, Entrepreneurial Ventures and Business Incubation at Asheville-Buncombe Technical Community College. He received a B.S.B.A in Management from Appalachian State University, M.B.A from Western Carolina University and is currently a doctoral student at Western Carolina University in Educational Leadership. Yelton is a former owner of several technology companies and currently program developer for a business incubator facility comprised of a FDA approved commercial kitchen, biotechnology space with wet and dry labs, light manufacturing and executive office space.

SPONSORS

THE CENTER FOR GLOBAL INITIATIVES is a catalyst for the innovative work of faculty and students at The University of North Carolina at Chapel Hill. Formerly known as the University Center for International Studies (UCIS), the Center for Global Initiatives strives to be entrepreneurial and nimble in its approach to fostering initiatives that deepen knowledge and understanding of our complex world. For its work, the Center is recognized by the U.S. Department of Education as one of only nine National Resources Centers for Global Studies. gi.unc.edu





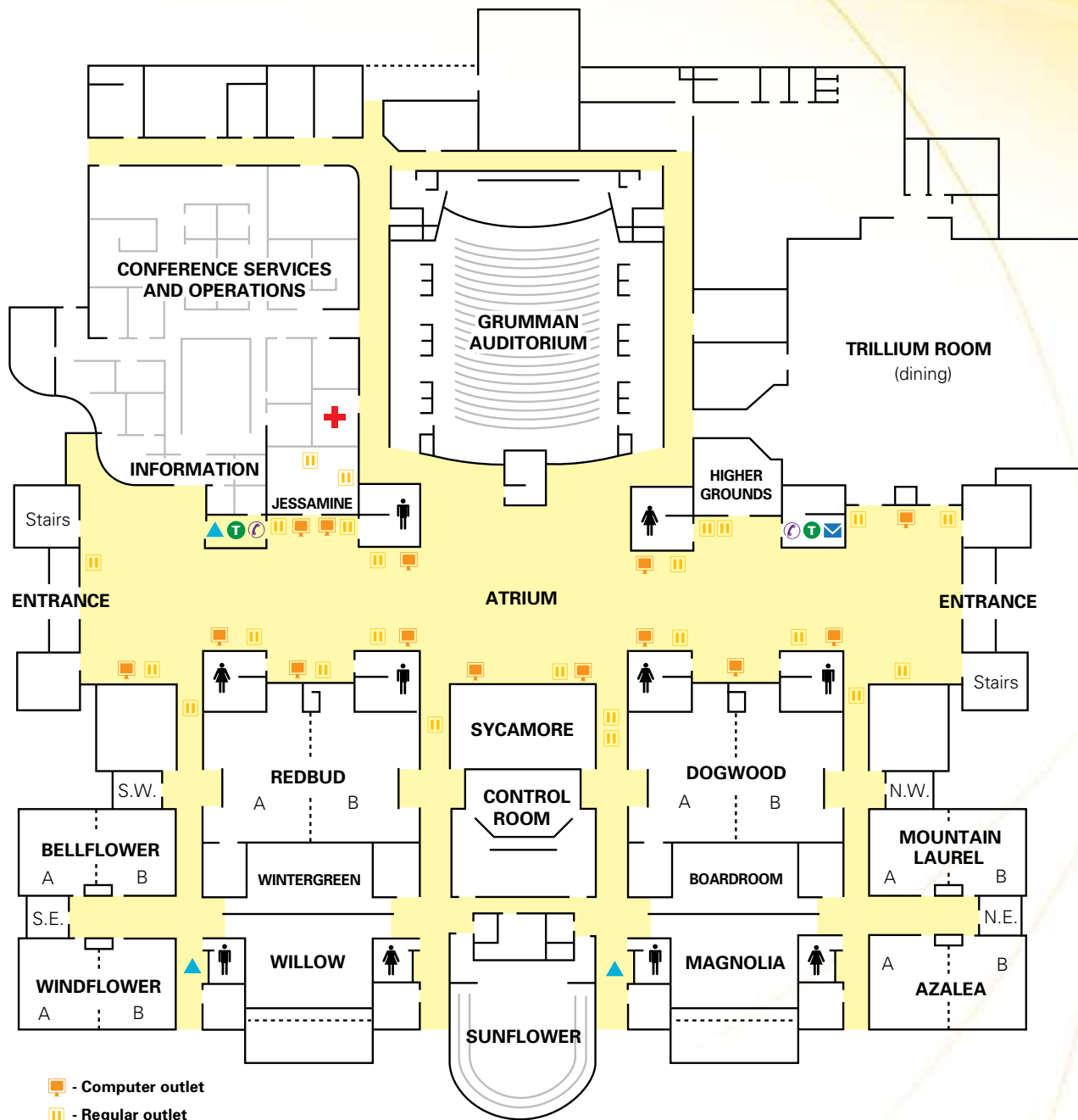

THE CENTER FOR THE STUDY OF THE AMERICAN SOUTH was established in 1992 by the University of North Carolina Board of Governors to confirm the University's long-standing commitment to its own region. The Center fosters outstanding scholarship exploring every aspect of the South's rich though often painful past and supports the region's democratic and progressive future. Its programs emphasize southern history, literature, and culture as well as ongoing social, political, and economic issues. www.unc.edu/depts/csas

THE OFFICE OF ECONOMIC AND BUSINESS DEVELOPMENT was launched April 1, 2004 and reflects the expanding efforts of The University of North Carolina at Chapel Hill to comprehensively address economic development issues facing North Carolina. As a designated point-of-contact between the University and North Carolina businesses and communities, OEBD facilitates economic development partnerships that benefit all North Carolinians. research.unc.edu/oebd/index.php

QUINTILES TRANSNATIONAL CORP is the world's leading pharmaceutical services company. Headquartered near Research Triangle Park, North Carolina, Quintiles employs over 16,000 people in over 50 countries aiding pharmaceutical and biotechnology companies to develop new medicines through state of the art partnerships in clinical trials, biostatistical studies, data management and analysis, laboratory services, marketing solutions and innovative investment strategies. Of the thirty top-selling drugs in the world for the past five years, Quintiles has helped develop or market every one. www.quintiles.com

LOCATION



-  - Computer outlet
-  - Regular outlet
-  - Local phone
-  - Campus phone
-  - E-mail stations
-  - Pay phone
-  - First Aid

THE WILLIAM AND IDA FRIDAY CENTER FOR CONTINUING EDUCATION

